

1-1-2014

BD Owens Library Virtual Tour 1.10.14

Cheryl Blevens
Indiana State University

Follow this and additional works at: <https://scholars.indianastate.edu/libfac-staff>

Recommended Citation

Blevens, Cheryl, "BD Owens Library Virtual Tour 1.10.14" (2014). *Library Faculty and Staff*. 53.
<https://scholars.indianastate.edu/libfac-staff/53>

This Article is brought to you for free and open access by the Cunningham Memorial Library at Sycamore Scholars. It has been accepted for inclusion in Library Faculty and Staff by an authorized administrator of Sycamore Scholars. For more information, please contact dana.swinford@indstate.edu.

An Explanation

The staff of Cunningham Memorial Library's Public Services Department is currently engaged in exploring the implementation of a "combined services" model wherein the Reference "Ask" desk and the Circulation Desk would be combined into a single service point. A useful part of the investigative process is being able to consult with libraries who already employ this model. One such library is the B. D. Owens Library at Northwest Missouri State University. Two of the Reference Librarians toured this institute and prepared the following PowerPoint for sharing with their colleagues.

Cheryl Blevens

January 10, 2014

A Pictorial Tour of
the B. D. Owens Library
Northwest Missouri State University
Maryville, Missouri
November 1, 2013



“The library, in the broad sense of the word, is not dead. It’s an actual place and there’s a need for it to be a place. It’s a vital part of student life and student development. It’s both a real and a virtual extended classroom, and I challenge anyone who claims technological advances will be the demise of libraries. Technology complements libraries. It doesn’t replace them.”

NMSU President Dr. John Jasinski, at the library’s re-opening, Sept. 14, 2011.



Northwest Missouri State University Facts:

- 135 undergraduate programs and 36 master's programs.
- Every full-time student receives a laptop computer to use throughout the school year.
- A textbook rental program where students pay only \$6 per credit hour for their textbooks.
- 6,485 students (5,542 undergraduate, 943 graduate) with a student to teacher ratio of 21 to 1.
- 63.4% in-state, 27.3% out-of-state, 5.5% international enrollment, 12% minority enrollment.
- Students represent 45 states and 30 countries.



B. D. Owens Library

B.D. Owens Library, opened in 1983 and remodeled in 2011, is a 116,000 square foot facility designed to meet the learning and research needs of Northwest students, faculty, and staff. The library building houses over 368,000 books, documents and bound periodicals, nearly 30,000 electronic format periodicals and approximately 58,000 eBooks, with additional access to over 24 million items through the statewide catalog maintained by the Missouri Consortium of Academic Libraries (MOBIUS). MOBIUS items arrive in 2-3 working days. ILL service is available for materials not available within the state. The library collection and services support scholarly research and provide current information that promotes student competencies concerning lifelong learning, critical thinking, communication and research.

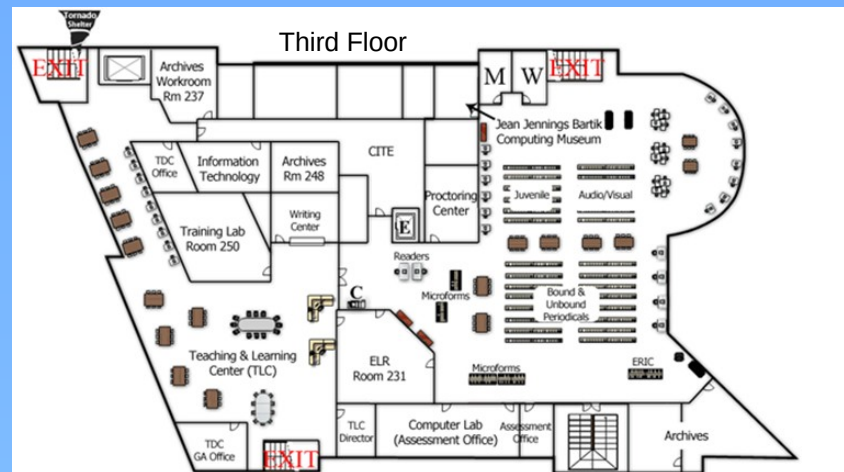
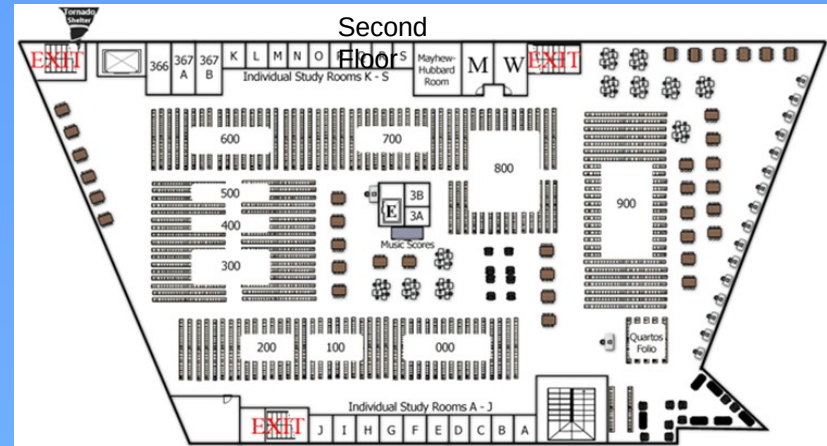
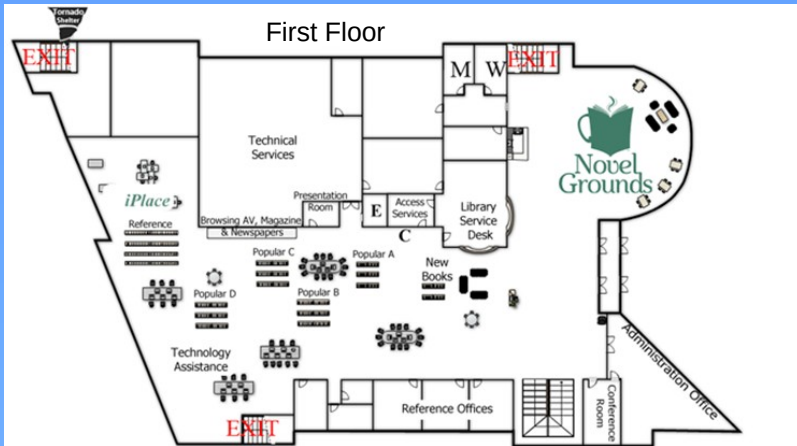

Floor Plans



Lobby Area, Library Services Desk ("Triage") on the Right with "Novel Grounds" (the De Rigueur Starbucks) tucked in behind it.

At the Library Services Desk, an inquiry is either answered or referred to a librarian. The library's very popular "Help with Research" program provides students, faculty, and staff with personalized research assistance on a specific, well-defined topic. Course-focused guides and tutorials along with reference and citing assistance are available. Other resources include Information Services, the Electronic Classroom and the Training Room, which serve as instructional and presentation areas with computers at each student work station and a Presentation Lab to enable students to practice giving presentations.

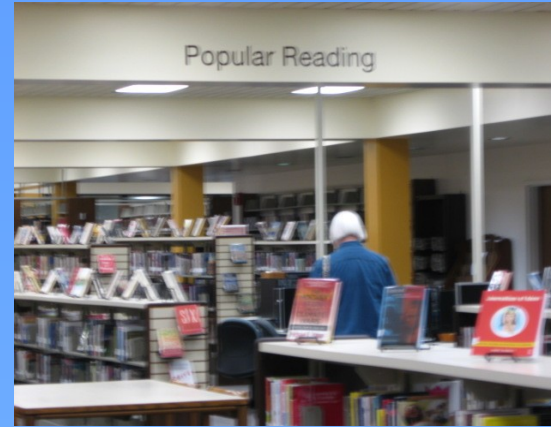

Main Floor, Admin Offices & Tech Assistance to the Left, Popular Reading & Reference Collection to the Right.

The library collection and services support scholarly research and provide current information that promotes student competencies concerning lifelong learning, critical thinking, communication and research. Throughout the library, areas for private study and reading are available along with spaces and resources that facilitate student group and team project development. On the first floor, the "browsing collection" is out and the "popular collection" is in, creating a bookstore approach with displays of fiction and non-fiction books that invite patrons to interact with the resources.



iPlace

"I-Place," which is short for Innovation Place, is located in a corner of the library's first floor. It is outfitted with rolling chairs, tables and white boards that make the space ideal for group collaboration. The walls also are covered with Plexiglass on which students can scribble notes. The furniture, library staff have observed, often ends up in a different configuration than the day before, and that's a good thing, they say.



Second Floor Shared Spaces

The library's second floor is home to several key services that complement its instructional support mission. The Assessment Office, Writing Center, Teaching Resources Area, and the Center for Informational Technology in Education (CITE) which administers and supports the University's instructional technology needs are all located on the second floor. The Writing Center offers writing across the curriculum, and tutoring by English department undergraduate and graduate students. The Talent Development Center also offers free tutoring and academic support across the curriculum.



Workstations Both Singular & Collaborative

Throughout the library, areas for private study and reading are available along with spaces and resources that facilitate student group and team project development. Computer terminals that once were grouped together are now scattered throughout the first floor, mixed among work tables and book shelves. Tables with embedded power strips are particularly popular.

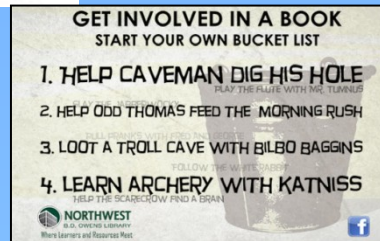
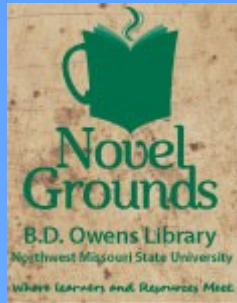

Signage, Services, and Displays



And in Closing: the Centennial Statue, Celebrating "100 Years of Traditions and The bronze life-sized sculpture, sculpted by Gregory Johnson to commemorate the University's centennial, stands in the east plaza of the J.W. Jones Student Union. It depicts two students – one from 1905 and one from 2005—studying on a bench. The young man, wearing knee-high boots and a cap, is shown reading a book, with a stack of books bound with a book strap and topped by an apple beside him. The woman, wearing jeans, boots and a “hoodie” jacket, holds an open notebook computer. Her cell phone and backpack are close by. The statue was installed in September 2005 and was funded through \$70,000 in donations.